



Transition Networks offers a full suite of networking connectivity solutions including media converters, NICs, SFP and GBIC modules, and the Milan brand of switches and wireless access products. The company designs and markets these technologies across a broad spectrum of protocols including Ethernet, Fast Ethernet, Gigabit Ethernet, T1/E1, DS3, ATM, and V.35. Transition Networks distributes these hardware-based connectivity solutions exclusively through a network of resellers and distributors in 50 countries.

- ▶ **Free Worldwide Technical Support** via the web or telephone
- ▶ **Built to Perfection**  
99.4% of Transition Networks's products are delivered without functional failure
- ▶ **ISO 9001 2000** Quality System Certified
- ▶ **ISO 14001** Environmental Certification
- ▶ **Lifetime Warranty** on all Transition Networks brand products (including power supply and fan)
- ▶ **100% Channel**  
100% of Transition Networks's products are distributed exclusively through the channel
- ▶ **Transition NOW**
  - "Chat" Live via the Web
  - Free Live Web-based training with 12 – 16 seminars per month

## CONTACT US

### Worldwide Headquarters & U.S. Sales

6475 City West Parkway  
Eden Prairie, MN 55344 USA  
tel: 952.941.7600  
toll free: 800.526.9267  
fax: 952.941.2322

sales@transition.com  
info@transition.com  
techsupport@transition.com  
www.transition.com

### Sales Offices

#### North America Canada

tel: +1-603-750-7169  
fax: +1-815-360-7401

#### Latin America Mexico, Central America, Caribbean

tel: +1-952-996-1517  
fax: +1-952-941-2322

#### South America

Office: +1-727-812-9656  
Mobile: +1-954-376-1037  
Fax: +1-952-941-2322

#### Brazil

tel: +55 11 8244-7630

#### Europe

#### EMEA Headquarters / Germany

tel +49 611 974 8460  
fax +49 611 950 4672

#### Eastern & Southern Europe

tel +420 2 2426 6901  
fax +420 2 2426 6854

#### Sweden

tel/fax +46 8 243 454

#### United Kingdom

tel +44 1691-830016  
fax +44 1691-830876

#### Asia

**China / Hong Kong**  
tel +1-952-941-7600  
fax +1-952-941-2322

#### India

tel +65 6288-9810  
fax +65 6234-0564

#### Japan

tel +81 03 3357 9980  
fax +81 03 5360 4480

#### Southeast Asia

tel +65 6288-9810  
fax +65 6234-0564



## THE NEW CHOICE IN INDUSTRIAL NETWORKING

CONVERSION & SWITCHING FOR INDUSTRIAL ENVIRONMENTS  
FROM THE NETWORK CONNECTIVITY EXPERTS

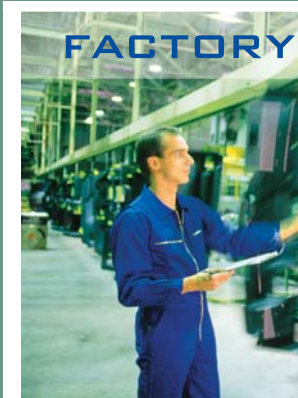

FACTORY



CONVERSION & SWITCHING

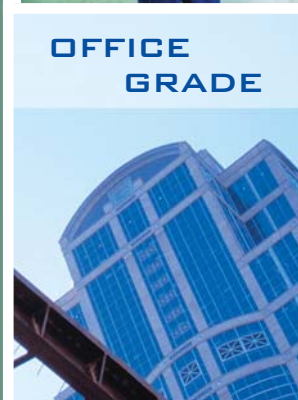

OFFICE  
GRADE



EXTENDED



TEMPERATURE



OUTDOOR

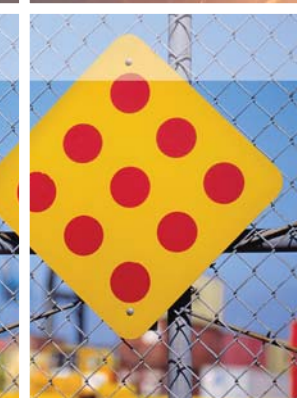

SUBSTATION

Transition Networks offers the most comprehensive industrial networking portfolio to connect your controlled office environment to your extended temperature, factory floor and substation environments. Manage your network and integrate fiber optics with Transition's industrial media converters, switches, device servers and substation products. All Transition product comes with a lifetime warranty.

900123

©2007 Transition Networks, Inc.  
All trademarks are the property of their respective owners.  
Technical information is subject to change without notice.

# INDUSTRIAL NETWORKING

- ▶ Eliminate EMI concerns easily & affordably with fiber cabling
- ▶ Extend the life of copper equipment and avoid costly equipment upgrades
- ▶ Maximize efficiency and control by using SNMP management to access remote devices
- ▶ Connect legacy equipment such as PLCs and automation systems to high speed networks
- ▶ Increase product uptime and reliability by using Extended Temperature converters in non-climate controlled environments
- ▶ Future proof networks; allowing companies to keep up with technology while keeping within budget

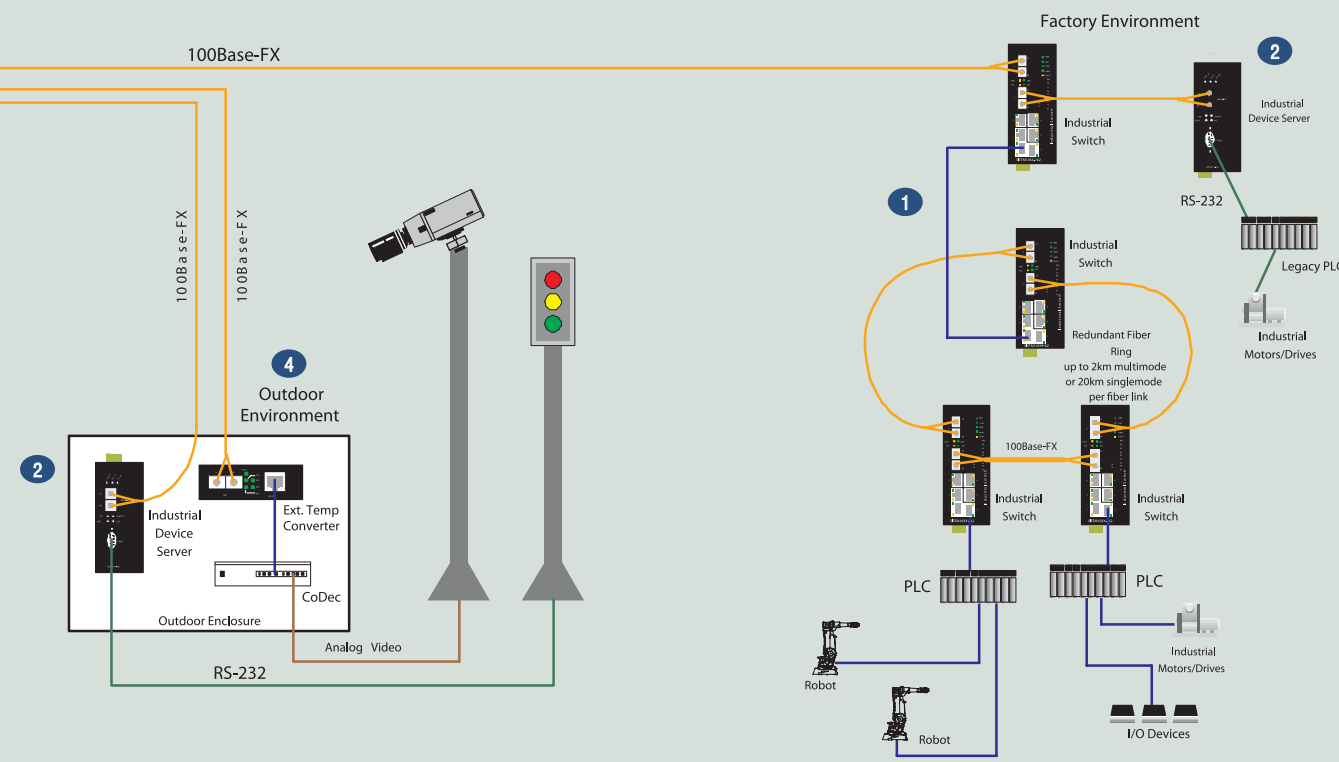
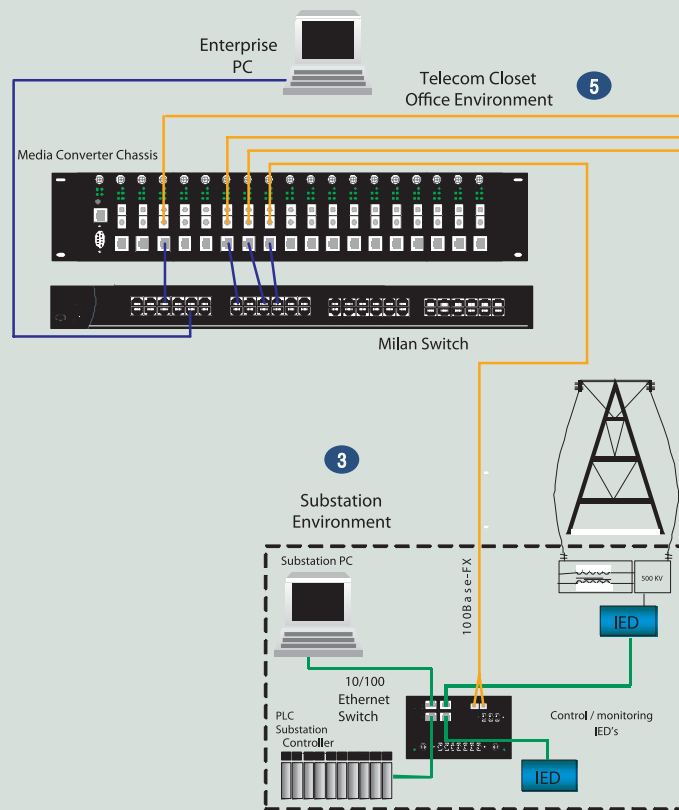

## Factory Floor Products

<b>SISTF101x-111-LRx</b> (1) 10/100BASE-TX to (1) 100BASE-FX Unmanaged Industrial Media Converter	<b>SISTF101x-141-LRx</b> (4) 10/100BASE-TX to (1) 100BASE-FX Unmanaged Industrial Switch	<b>SISTF101x-150-LRx</b> <b>SISTF101x-180-LRx</b> (5) or (8) 10/100BASE-TX Unmanaged Industrial Switch	<b>SISTM101x-1xx-LRx</b> (6) 10/100BASE-TX to (2) 100BASE-FX or (8) 10/100 BASE-TX Managed Industrial Switches	<b>SDSFE311x-100</b> RS232 to 100BASE-FX Managed Industrial Device Server	<b>SDSFE321x-110</b> RS422/485 to 100BASE-FX Managed Industrial Device Server

**1 Industrial Media Converters & Switches**      **2 Industrial Device Servers**

## 5 Office Grade Products

<b>E-100BTX-FX-05(xxxx)</b> Stand-Alone	<b>CFETF10xx-105</b> Chassis Card	<b>Mx/E-PSW-FX-01(xx)</b> Mini Stand-Alone	<b>SPOEB10(xx)-1(xx)</b> Ethernet/Fast Ethernet Power-over-Ethernet Copper to Fiber Media Converters	<b>POE Remotely Managed Switch</b> 24-port POE 10/100BASE-TX + (2) SFP/1000BASE-T Ports (POE Accessories Available)	<b>Multi-Layer Gigabit Ethernet Managed Switch</b> 24-port 10/100/1000TX + 4 ports for Combo SFP/1000BASE-T

## 3 Substation Products

<b>SIBTF10xx-1xx-Mx</b> Substation-Rated 10/100 Unmanaged Industrial Switch

## 4 Extended Temperature Products

<b>E-100BTX-FX-05(xxHT)</b> Fast Ethernet Media Converter	<b>E-TBT-FRL-05(xxHT)</b> Ethernet Media Converter	<b>MIL-SM8002TG</b> Indoor/Protected Outdoor Remote IP-Managed 10/100/1000 Switch

<b>SDSFE3110-120</b> DB-9 to RJ-45	<b>SDSFE311x-120</b> DB-9 to Fiber	<b>CPSMCxxx0-xx0</b> Point System™ Managed Chassis	<b>MIL-SM801P(xx)</b> 8-Port 10/100 Layer 2 Managed Switch with 100BASE-FX Uplink Port

**Managed Device Servers**